

Dial Indicator

FEATURES

- Shockproof movement
- High contrast dial face
- Adjustable tolerance markers
- Chrome plated housing
- Lifter protection cap on the measuring spindle
- Precision gears and pinions
- Package contains: case

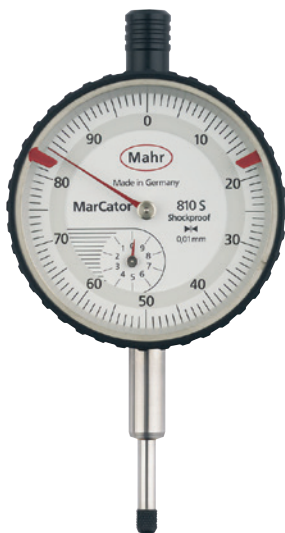

Application:

The measuring pin is retracted by spring, contacting and the measuring force are triggered manually (by hand) by touching the button on the upper sleeve

TECHNICAL DATA

| Order no. | | 4311000 | 4311050 | 4311060 | 4321000 | 4329050 |
|--|----|---------|-----------|---------|------------------|---------|
| Product type | | 810 S | 810 A | 810 AT | 810 SV | 810 AU |
| Measuring span | mm | | 10 | | 40 | 10 |
| Graduation value | mm | | | 0.01 | | |
| Type of dial face | | 0 – 100 | | 100 – 0 | 0 – 100 | 100 – 0 |
| Range per rev. | mm | | | 1 | | |
| Error limit, measuring range | µm | | 15 | | 25 | 15 |
| Error limit, 1 revolution | µm | | 10 | | 15 | 10 |
| Error limit, 1/2 revolution | µm | | 9 | | 10 | 9 |
| Error limit, 1/10 revolution | µm | | | 5 | | |
| Repeatability f_w | µm | | 3 | | | 5 |
| Hysteresis f_u | µm | | 3 | | 6 | 5 |
| Overtravel | mm | 0.1 | | 0.8 | | 0.1 |
| Measuring force incoming measuring pin | | | 0.7 – 1.3 | | 0.8 – 1.8 | - |
| Standard | | | DIN 878 | | Factory standard | |
| Shockproof movement | | • | | | • | |
| Lifting protection cap | | | | • | | |
| Reverse measuring force direction | | | | | | • |
| Dial color | | | | White | | |

| Order no. | a | b | c | d | e | f | g | Mounting shaft | Scale diameter |
|-----------|----|------|-----|----|-----|----|-----|----------------|----------------|
| | mm | mm | mm | mm | mm | mm | mm | mm | mm |
| 4311000 | 58 | 23 | 7.5 | 52 | 112 | 21 | 16 | 8 | 50 |
| 4311050 | 58 | 23 | 7.5 | 52 | 112 | 22 | 15 | 8 | 50 |
| 4311060 | 58 | 23 | 7.5 | 52 | 112 | 22 | 15 | 8 | 50 |
| 4321000 | 58 | 24.2 | 8.7 | 52 | 169 | 22 | 45 | 8 | 50 |
| 4329050 | 58 | 23 | 7.5 | 52 | 112 | 22 | 4.5 | 8 | 50 |

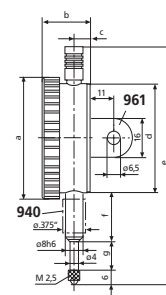

ACCESSORIES

| Order no. | Product name | Product type |
|-----------|-------------------------------|--------------|
| 4310103 | Adapter bush (.375" / 8 mm) | 940 |
| 4373020 | Splash proof cap (58 mm) | 955 |
| 4375010 | Lug back, vertical, for 810 | 961 |
| 4375011 | Lug back, horizontal, for 810 | 962 |