

Futtertyp / Chucktype: **B-206**
 Hersteller / Maker: **Kitagawa**
 Nutbreite / Slot width: **12 mm**
 Verzahnung / Serration: **1,5x60°**

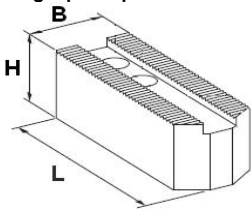

Angespitzt / pointed



Weiche Aufsatzbacken / Soft Top Jaws					Satz = 3 Stück / Set = 3 pieces
L	B	H	kg	article no.	
72	30	30	0.90	KSJ-06-P	
82	30	30	1.20	KSJ-06L-82-P	
72	35	35	1.35	KSJ-06W-35x35-P	
72	50	50	3.60	KSJ-06W-50x50-P	
72	30	50	2.00	KSJ-06H-50-P	
72	30	60	1.95	KSJ-06H-60-P	

Flach / Flat

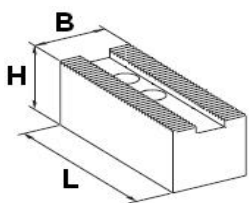

Weiche Aufsatzbacken / Soft Top Jaws					Satz = 3 Stück / Set = 3 pieces
L	B	H	kg	article no.	
72	30	30	0.90	KSJ-06-F	
72	30	80	2.70	KSJ-06H-80-F	
72	30	100	3.30	KSJ-06H-100-F	

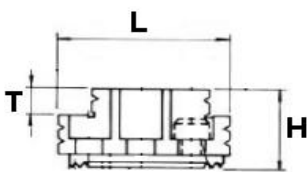

Gehärtete umkehrbare Stufenbacken / Hard top reversible jaws step type					Satz = 3 Stück / Set = 3 pieces
L	B	H	T	kg	article no.
67.5	31	35	12	2.70	HB06B1

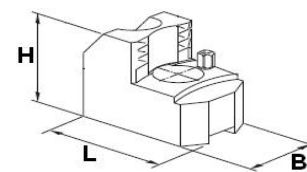

Gehärtete Greiferbacken / Hard top gripper jaws					Satz = 3 Stück / Set = 3 pieces
L	B	H	Spannbereich / gripping range	kg	article no.
76	30	40	30-50 mm	1.00	KGJ-06-3050
68	30	40	50-70 mm	0.90	KGJ-06-5070
63	35	50	70-90 mm	1.10	KGJ-06-7090
58	40	50	90-110 mm	1.50	KGJ-06-9011
63	40	50	110-130 mm	1.60	KGJ-06-1113

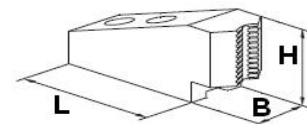

Gehärtete Greiferbacken für kleine Durchmesser / Hard top gripper jaws for small diameters					Satz = 3 Stück / Set = 3 pieces
L	B	H	Spannbereich / gripping range	kg	article no.
79	30	40	4-15 mm	1.30	KGJ-06-0415
75	30	40	15-30 mm	1.20	KGJ-06-1530

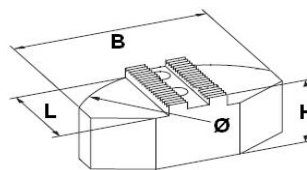

Segmentbacken, Ø 3 Backen = 165mm / Pie Jaws Ø 3 Jaws = 165mm					Satz = 3 Stück / Set = 3 pieces
L	B	H	Material	kg	article no.
60	120	40	Stahl / steel	3.20	KPJ-06
60	120	49	Aluminium	1.70	KPJ-06-A

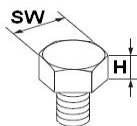

Auflagebolzen M10 / Screws for gripper jaws M10				Satz = 3 Stück / Set = 3 pieces
H	SW	kg	article no.	
5	10	0.03	KWS-56	
10	10	0.04	KWS-106	
15	10	0.04	KWS-156	
20	10	0.06	KWS-206	

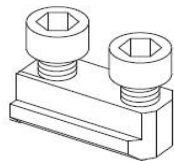

Doppelte Nutensteine passend für B-206 / Double T-Nuts for B-206		Satz = 3 Stück / Set = 3 pieces
kg	article no.	
0.15	TNS-B206	

Version : 07/2013

Druckfehler, Irrtümer und Änderungen vorbehalten / Misprints and errors excepted