

DIGITAL RTJ RING GROOVE CALIPER

DATA
OUTPUT

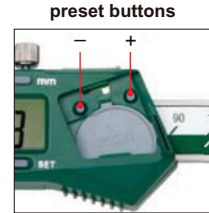

1179-300



1179-600

Unit: mm

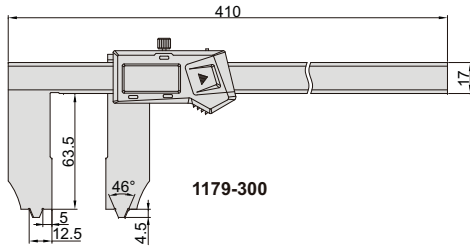

1179-300

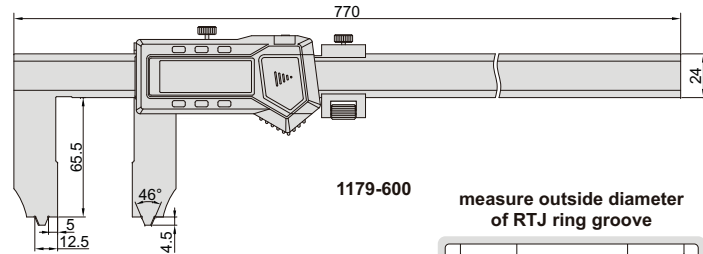

1179-600

- Measure ring grooves of flange
- Resolution: 0.01mm/0.0005"
- Button function: on/off, set, zero, mm/inch, data preset
- Battery CR2032
- Data output
- Made of stainless steel
- Optional accessory: data output cable (code 7306-20, 7302-SPC1A/SPC1B, 7305-SPC2)

applicable for RTJ ring grooves with angle 23°

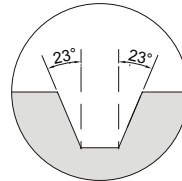

measure outside diameter of RTJ ring groove

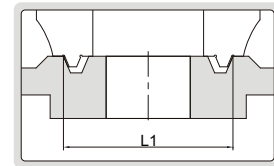

measure inside diameter of RTJ ring groove

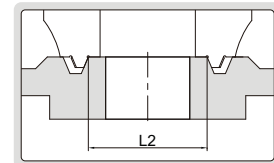

Code	Range (inside diameter of RTJ ring groove)	Range (outside diameter of RTJ ring groove)	Angle of RTJ ring groove	Accuracy
1179-300	10-300mm/0.4-12"	25-300mm/1-12"	23°	±0.06mm
1179-600	10-600mm/0.4-24"	25-600mm/1-24"	23°	±0.07mm